

This manual covers units: May 7, 2015 to Date

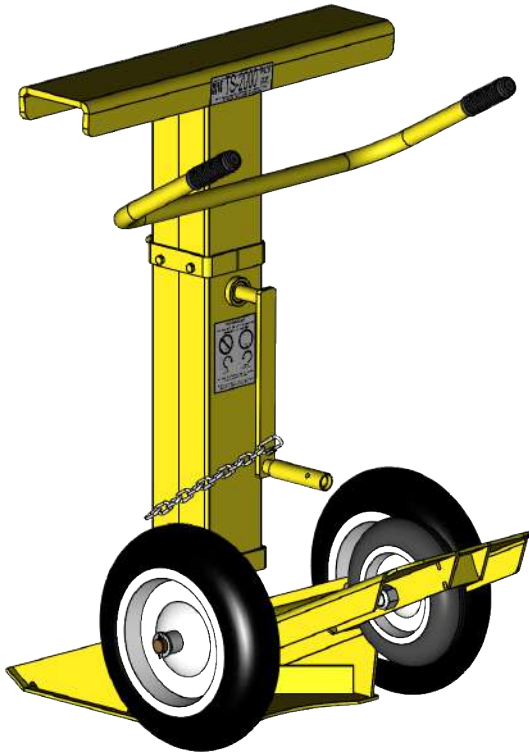

NOTICE TO USER	2
SAFETY	2
INSTALLATION (OPTIONAL)	
Transport Wheel Assembly (OPTIONAL) . . .	3
OPERATION	
Position TS-2000	4
Remove TS-2000	4
MAINTENANCE	5
PARTS	6
Exploded View	6
WARRANTY	8

Model: **TS-2000**

Manual Part #: **54450042**

NOTICE TO USER

Thank you for purchasing a Rite-Hite® product.

The TS-2000 Trailer Stand is a heavy duty trailer stand providing additional safety to a parked trailer resting on its landing gear.

Capacity: 100,000 lbs [45400 kg].

The English version of this manual shall prevail over any error in, or conflicting interpretation of, any translations.

Rite-Hite reserves the right to substitute and/or modify parts and drawings. If separate prints are included with the unit, they supersede those contained in the manual.

For best results, have this product serviced by an authorized Rite-Hite representative.

A Planned Maintenance Program (P.M.P.), customized to your specific operation is available and recommended. For a P.M.P., contact your local Rite-Hite representative or Rite-Hite technical support at (U.S.) 1-414-973-3625 or 1-888-456-3625, (S.A.) +55 21 99616 4421, (E.U.) +49-5693 98700.

Manufactured by Rite-Hite Engineered Solutions Group, Inc.

SAFETY

Safety Identifications

DANGER

Indicates a hazardous situation which, if not avoided, will result in death or serious injury.

Indique une situation dangereuse qui, si elle n'est pas évitée, peut entraîner la mort ou de graves blessures.

WARNING / AVERTISSEMENT

Indicates a hazardous situation which, if not avoided, *could result in death or serious injury.*

Indique une situation dangereuse qui, si elle n'est pas évitée, *peut entraîner la mort ou des blessures graves.*

CAUTION / ATTENTION

Indicates a hazardous situation which, if not avoided, *could result in minor or moderate injury.*

Indique une situation dangereuse qui, si elle n'est pas évitée, *peut entraîner des blessures légères à modérées.*

NOTICE

Indicates a situation which can cause damage to the equipment, personal property and/or the environment, or cause the equipment to operate improperly.

NOTE: A note is used to inform you of important installation, operation, or maintenance information.

INSTALLATION (OPTIONAL)

Transport Wheel Assembly (OPTIONAL)

Verify you received all components before installation. Notify your authorized Rite-Hite® Representative if parts are missing or damaged.



- 1 Transport wheel support weldment (yellow)
- 1 10in solid rubber wheel
- 1 1in wheel axle bolt and nylock nut
- 2 3/8in U-bolts with lock nuts

Figure 1

Tools Required:

- 1 9/16in wrench
- 2 large channel lock pliers or vice grips

For easier assembly, tip trailer stand over (front of stand on pavement).

NOTE: 2 people are required to tip trailer stand over and bring it back to vertical position.



Figure 2

1. Install wheel into weldment by inserting wheel into slot in weldment and sliding axle bolt through holes provided.
 - Tighten axle bolt securely. Engage bolt into nylon portion of nut (A).
 - **DO NOT** over-tighten or restrict wheel rotation.
2. Remove nuts from U-Bolts and slide U-Bolts from weldment.
3. Slide weldment into position under trailer stand axle until holes for U-Bolts align with axle.
 - Install U-Bolts around trailer stand axle and down through weldment holes.
 - Install the nylon lock nuts onto the U-Bolts.
 - Tighten the nuts securely and evenly (B).

OPERATION



WARNING / AVERTISSEMENT

DO NOT put arms or hands between the trailer and the TS-2000-Trailer Stand.

Ne mettez pas de bras ou les mains entre la remorque et le TS-2000-Trailer Stand.



Figure 3

Position TS-2000

1. Confirm vehicle restraint and/or wheel chocks are securely in position.
2. Adjust height of landing gear, if necessary. Trailer must be horizontal.
3. Roll trailer stand into position (A). It must fit underneath the nose of the trailer without any interference. If necessary turn height adjustment crank counter clockwise to decrease the height. The top plate of the trailer stand should be flush with trailer front wall.
4. With the TS-2000 in this position, turn height adjustment crank clockwise so that it is closely against the underside of the trailer's nose (B). Rotate height adjustment crank to closest position backward where it is pointed downward. It is acceptable to have a gap of up to 1in [25 mm] between top of trailer stand and bottom of trailer.
5. Drop looped chain over height adjustment crank of trailer stand to secure position (C).

Remove TS-2000

1. Tractor should stand-by to be coupled with trailer.
2. Confirm vehicle restraint and/or wheel chocks are securely in position.
3. Check height of landing gear. It should firmly touch the ground.
4. Lift chain off height adjustment crank and allow it to rest on rotating shaft.
5. Turn height adjustment crank counter clockwise to crank down the TS-2000 to allow trailer stand to roll out.
NOTE: If trailer stand is tight, remove weight from trailer stand by cranking up legs of trailer so trailer stand can be removed smoothly (without jerking).
6. Remove trailer stand.
7. Allow tractor to connect with trailer.
8. Disengage any vehicle restraints or wheel chocks.
9. Clean and store the TS-2000.

MAINTENANCE

Before each use:

INSPECT	REMEDY
Bent parts (eg. handles, top cover, or height adjustment crank)	Replace broken or bent parts.
Welds for breaks	
Chain is attached	
Trailer stand is able to move and operate freely.	Lubricate the wheels.
	If there is binding in main structure, contact your authorized Rite-Hite service representative to disassemble top section and determine cause.

PARTS

Exploded View

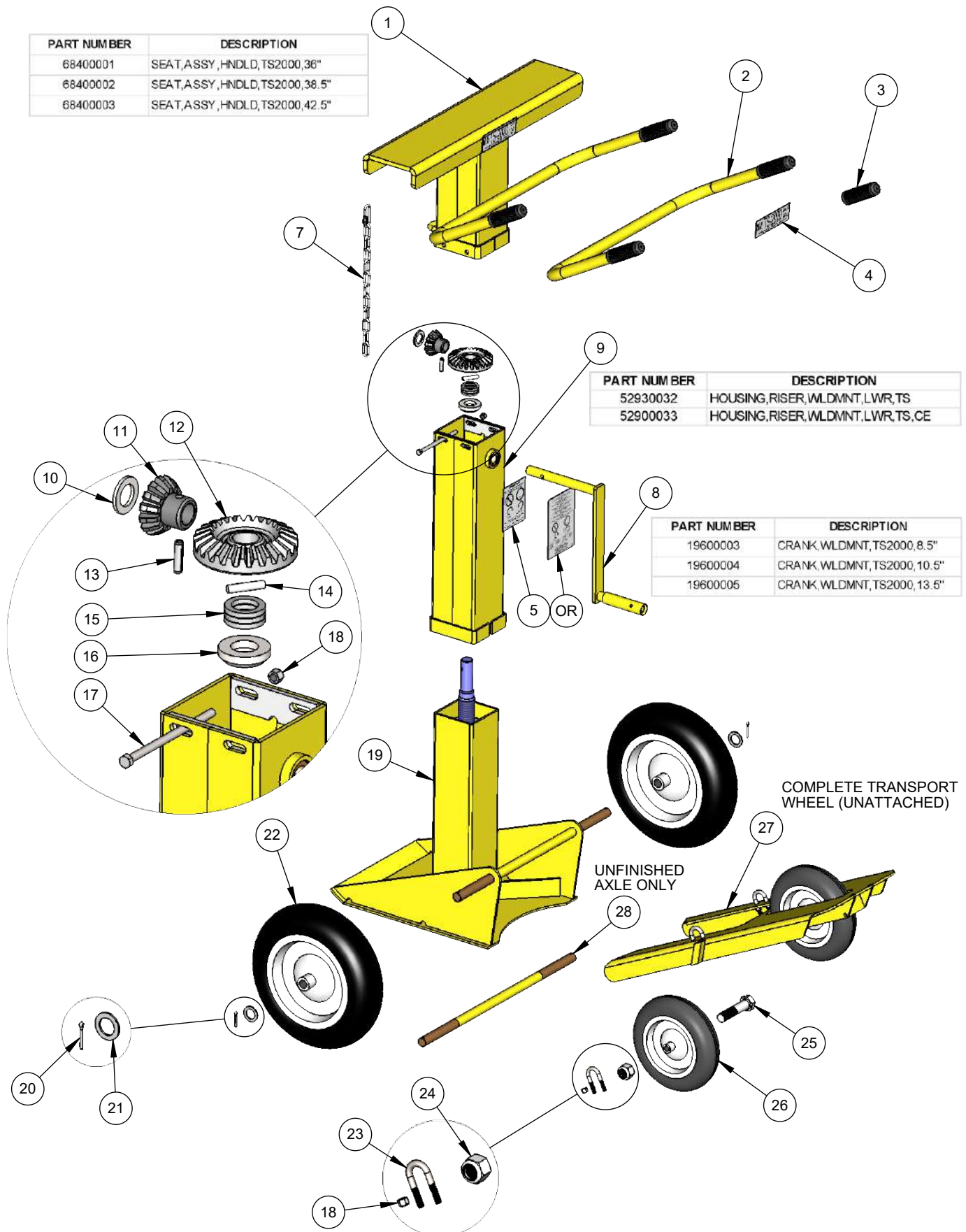

PARTS

Exploded View *Continued*

#	DESCRIPTION	PART #
1	SEAT, ASSY,HNDLD, TS2000,36"	68400001
	SEAT, ASSY,HNDLD, TS2000,38.5"	68400002
	SEAT, ASSY,HNDLD, TS2000,42.5"	68400003
2	HANDLE,BAR W/GRIPS,TS2000	51850054
3	GRIP,HANDLE,VINYL,1-1/4ODX4-1/2"	55150278
4	LABEL,PRODUCT,TS2000	53850675
5	LABEL,ROTATION,CAPACITY,TS2000	53850676
	LABEL,ROTATION,CAPACITY,TS,CE	53850690
7	CHAIN,ASSY,TS2000	16600068
8	CRANK,WLDMNT,TS2000,8.5"	19600003
	CRANK,WLDMNT,TS2000,10.5"	19600004
	CRANK,WLDMNT,TS2000,13.5"	19600005
9	HOUSING,RISER,WLDMNT,LWER,TS	52930032
	HOUSING,RISER,WLDMNT,LWER,TS,CE	52930033
10	SPACER,1-34ODX1IDX5/32	70450171
11	GEAR,PINION,BEVELED,2.75	51230002
12	GEAR,PINION,BEVELED,4.5	51230003
13	SMALL GEAR SPRING PIN	64010012
14	PIN,DOWEL,3/8X2,STL	64040037
15	BRG,THRUST,1.253 ID X 1.872 OD	12500050
16	SPACER,DRIVE,RISER,TS2000	70450172
17	SCR,HHMS,3/8-16X6.5,GR5,ZNC	67880145
18	NUT,HEX,NYL LOCK,3/8-16,ZNC	55630005
19	CHASSIS,WLDMNT,W/SHAFT,TS2000	51550279
20	PIN,COTTER,3/16X1-1/4	64030009
21	WSHR,FLAT,1-1/8X1-3/4X1/8,ZNC	74170030
22	WHEEL,RIM/TIRE,16ODX4WX1" BORE	75550016
23	BLT,U,3/8,1X1-3/4,SS	67880146
24	NUT,HEX,1-8,GR8,ZNC	55670016
25	SCR,HHMS,1-8,4-1/2,GR5,ZNC	67920012
26	WHEEL,RIM/TIRE,10ODX4WX1" BORE	75550018
27	COMPLETE TRANSPORT WHEEL (UNASSEMBLED)	75550017
28	AXLE ONLY, UNFINISHED	11860001

Rite-Hite Company, LLC and its affiliates (collectively "Rite-Hite") warrant that the Product sold to the Owner will be free of defects in design, materials and workmanship (ordinary wear and tear excepted) for the periods set forth below ("Limited Warranty").

Three (3) Year(s) on all mechanical and electrical parts (non-prorated).
One (1) Year(s) labor, based on Rite-Hite approved travel and labor repair times.

REMEDIES

Parts: Rite-Hite's obligations under this Limited Warranty are limited to repairing or replacing, at Rite-Hite's option, any part which is determined by Rite-Hite to be defective during the applicable warranty period. Such repair or replacement shall be Rite-Hite's sole obligation and the Owner's exclusive remedy under this Limited Warranty.

Labor: Rite-Hite will provide warranty service without charge for labor per the specified warranty period. Thereafter, a charge will apply to any repair or replacement under this Limited Warranty.

CLAIMS Claims under this Limited Warranty must be made (i) within 30 (thirty) days after discovery and (ii) prior to expiration of the applicable warranty period. Warranty period commences on the date of shipment. Claims shall be made in writing or by contacting the representative from whom the Product was purchased directly. Owner must allow Rite-Hite or its agent, a reasonable opportunity to inspect any Product claimed to be defective and shall, at Rite-Hite's option, either (x) grant Rite-Hite or its agent access to Owner's premises for the purpose of repairing or replacing the Product or (y) return of the Product to the Rite-Hite, F.O.B. Rite-Hite's factory.

NOT WARRANTED Rite-Hite does not warrant against and is not responsible for wear items such as fuses, batteries, bulbs, vision and seals. No implied warranty shall be deemed to cover damages that result directly or indirectly from: (i) the unauthorized modification or repair of the Product, (ii) damage due to misuse, neglect, accident, failure to provide necessary maintenance, or normal wear and tear of the Product, (iii) failure to follow Rite-Hite's instructions for installation, failure to operate the Product within the Product's rated capacities and/or specified design parameters, or failure to properly maintain the Product, (iv) use of the Product in a manner that is inconsistent with Rite-Hite's guidelines or local building codes, (v) movement, settling, distortion, or collapse of the ground, or of improvements to which the Products are affixed, (vi) fire, flood, earthquake, elements of nature or acts of God, riots, civil disorder, war, or any other cause beyond the reasonable control of Rite-Hite, (vii) improper handling, storage, abuse, or neglect of the Product by Owner or by any third party.

DISCLAIMERS THIS LIMITED WARRANTY IS EXCLUSIVE AND IN LIEU OF ALL OTHER REPRESENTATIONS AND WARRANTIES, EXPRESS OR IMPLIED, AND RITE-HITE EXPRESSLY DISCLAIMS AND EXCLUDES ANY IMPLIED WARRANTIES OF MERCHANTABILITY OR FITNESS FOR PURPOSE. RITE-HITE SHALL NOT BE SUBJECT TO ANY OTHER OBLIGATIONS OR LIABILITIES, WHETHER ARISING OUT OF BREACH OF CONTRACT, WARRANTY, TORT (INCLUDING NEGLIGENCE AND STRICT LIABILITY) OR OTHER THEORIES OF LAW, WITH RESPECT TO THE PRODUCTS SOLD OR SERVICES RENDERED BY RITE-HITE, OR ANY UNDERTAKINGS, ACTS, OR OMISSIONS RELATING THERETO.

LIMITATION OF LIABILITY IN NO EVENT SHALL RITE-HITE BE RESPONSIBLE FOR, OR LIABLE TO ANYONE FOR, SPECIAL, INDIRECT, COLLATERAL, PUNITIVE, INCIDENTAL, OR CONSEQUENTIAL DAMAGES, EVEN IF RITE-HITE HAS BEEN ADVISED OF THE POSSIBILITY OF SUCH DAMAGES. Such excluded damages include, but are not limited to, personal injury, damage to property, loss of goodwill, loss of profits, loss of use, cost of cover with any substitute product, interruption of business, or other similar indirect financial loss.

170714

GLOBAL SALES & SERVICE *Representatives in All Major Cities*

RITE-HITE WORLD HEADQUARTERS

8900 N. Arbon Drive
P.O. Box 245020
Milwaukee, Wisconsin 53224

☎ **414-355-2600**
U.S. Only: **1-800-456-0600**

RITE-HITE CHINA

First Floor, Building #3,
558 Tongxie Road,
Changning District
Shanghai 200335, China

☎ **+86-21-6237-6333**

RITE-HITE LATIN AMERICA

Alameda Lorena 800, Conj. 1310
- Jardim Paulista
São Paulo/SP, CEP 10424-001 - Brazil

☎ **+55-11-3527-9590**

RITE-HITE GMBH

Carl-Zeiss-Strasse 3
34471 Volkmarsen, Germany

☎ **+49-5693 98700**