

REVISION HISTORY

ITEM	QTY	PART NO.	DESCRIPTION
PARTS LIST / MATERIAL			

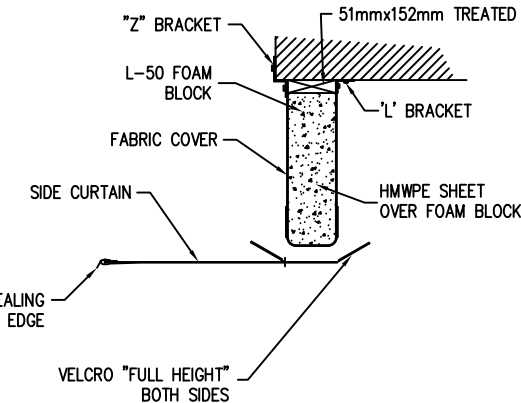

SIDE FRAME DETAILS

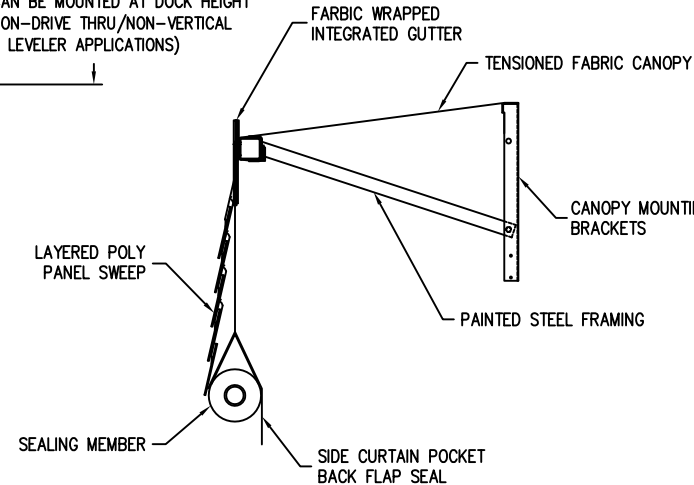

SEAL DETAILS

UNIT SPECIFICATIONS:
SEAL MEMBER: F114 22 PLUS, BLACK
SIDE FRAME: F114 22 PLUS, BLACK
SIDE CURTAIN: F510, BLACK DURATHON
TRUCK COVERAGE SHOWN: 3734mm - 4115mm

NOTES:

- APPLICATIONS THAT HAVE BUMPERS MOUNTED ABOVE DOCK HEIGHT (OR ABOVE THE PIT FLOOR IN VERTICAL LEVELER APPLICATIONS) MAY REQUIRE THAT THE BOTTOM OF THE SIDE MEMBERS BE MOUNTED AT THE TOP OF THE BUMPERS INSTEAD OF AT DOCK HEIGHT.
- VERTICAL LEVELER APPLICATION SHOWN ABOVE.
- MAXIMUM DOOR OPENING BASED ON CANOPY TYPE. CONSULT APPLICATIONS.
- THIS MODEL APPLICABLE FOR DRIVE THRU AND NON-DRIVE THRU APPLICATIONS. CONSULT APPLICATIONS.
- LEVEL GRADE REQUIRED FOR DRIVE THRU APPLICATIONS.
- 508mm MIN. TRAILER PENETRATION

INCH TOLERANCES				DO NOT SCALE DRAWING	
OVER	UP TO	+	-		
0	0.125	0.005			MM-DD-YY
0.125	0.25	0.010			
0.25	1.25	0.020			
1.25	5	0.030			
5	15	0.040			
15	40	0.080			
40	80	0.100			
80		0.125			

DRAWN BY	CJD	DATE	12/15/2011
CHECKED BY		DATE	
APPROVED BY		DATE	

INITIAL ECN	14-013
DATE ISSUED	3/10/2015

ANGLES	FINISH	UNFINISH	DEB	NONE
--------	--------	----------	-----	------

RITE-HITE
ENVIRONMENTAL ENCLOSURES CO.

ARCHITECTURAL APPROVAL
STD PITCH (METRIC)
ECLIPSE NH DOCK SHELTER

SIZE	MODEL NUMBER	DWG NO	REV
C	620NH	A7120145	